

0F3MR260G110000

FHQ-M010

EVOLUZIONE SLIPPER CLUTCH FOR HUSQVARNA 450

ASSEMBLY INSTRUCTIONS

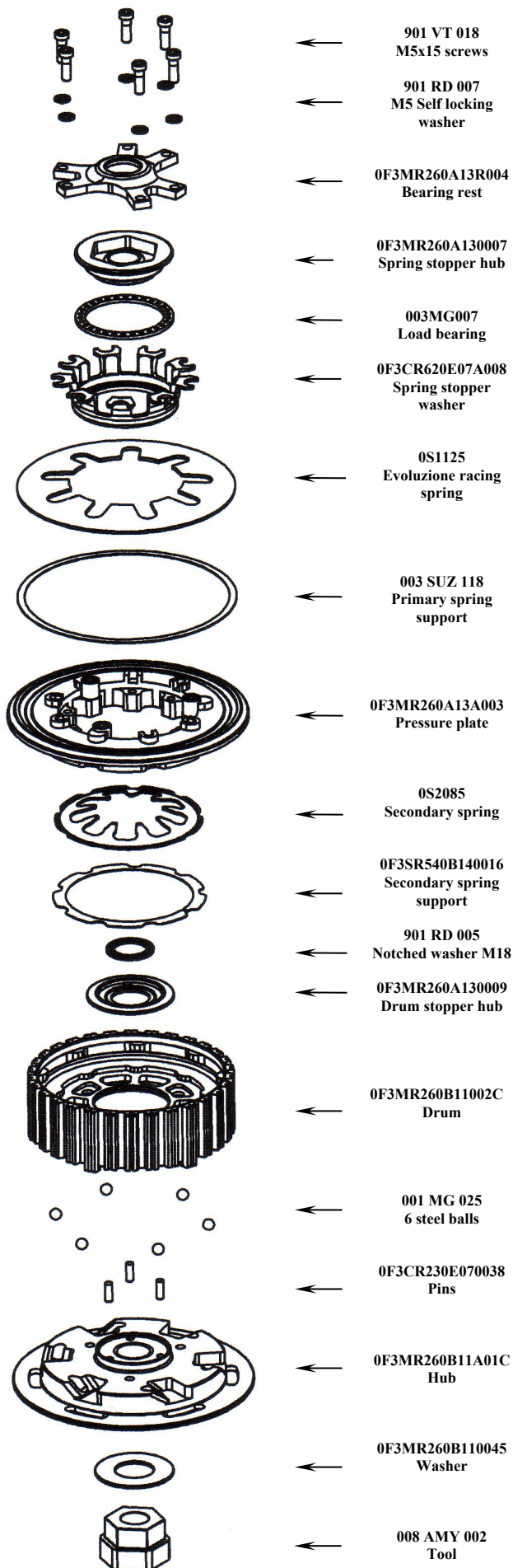

- Pre-assemble the hub pack: place the 6 steel balls (001MG025) at the bottom of the grooves of the hub (0F3MR260B11001C) using a small amount of grease. With an M6 screw fix the drum (0F3MR260B11002C) onto the hub (0F3MR260B11001C) in an at-rest position.

- Insert the hub pack onto the main shaft without remove the original spacer.

NOTE: from 2005 models insert the 1,5mm thickness washer (0F3MR260B110045) between the original spacer and the clutch hub (0F3MR260B11A01C) otherwise DO NOT insert it.

- Reinstall the clutch plates remembering to respect the position as in the original clutch. The total thickness of the disc pack should be 35.2 mm.

- Remove the previously mounted screw.

- Position the drum stopper hub (0F3MR260A130009) on the hub (0F3MR260B11A01C) with a small quantity of grease taking care that the three pins (0F3CR620E070038) inside the hub (0F3MR260B11A01C) place themselves into the three holes present on the drum stopper hub (0F3MR260A130009) and don't stick out from the surface where the spring stopper hub will place.

- Insert the notched washer (901RD005) in the upper part of the drum stopper hub (0F3MR260A130009), the convex part facing up.

- Place the secondary spring support (0F3SR540B140016) in the drum housing (0F3MR260B11002C).

- Using a little quantity of grease mount the secondary spring (0S2085) in its own housing inside the drum (0F3MR260B11A02C).

- Insert the pressure plate (0F3MR260A13A003) in the drum (0F3MR260B11002C), position the primary spring support (003SUZ118) inside the pressure plate (0F3MR260A13A003) and fit the Evoluzione Racing spring (0S1125).

- Insert the spring stopper washer (0F3CR620E07A008) inside the spring (0S1125) keeping the shaped part facing up as illustrated and making the 9 wings overlap the 9 spring tips (0S1125); fit the load bearing (003MG007) and finally the spring stopper hub (0F3MR260A130007).

- Screw the spring stopper hub onto the drive shaft, locking with the dynamometric key to the torque suggested by the manufacturer. For the assembly please use the tool (008AMY002) supplied with the clutch.

- Pre-assemble the complete bearing rest: mount the clutch pushrod piece, bearing and thrust washer of the original clutch into the bearing rest housing (0F3MR260A13R004).

- Position the bearing rest (0F3MR260A13R004) into the relevant opening of the pressure plate (0F3MR260A13A003) taking care to correctly align the openings and fix it with the six screws (901VT018) and with the previously dismounted self locking washers.

NB: once the assembly is completed, repeatedly operate the clutch lever to check that pressure plate correctly performs the opening and closing movements, then mount the clutch guard.

GENERAL SAFETY REGULATIONS

- IN THIS SHEET ARE REPORTED THE DIRECTIONS TO PERFORM CORRECTLY THE CLUTCH ASSEMBLY OPERATIONS.

- STM RESERVES THE RIGHT, WITHOUT NOTICE, TO INTRODUCE ANY TECHNICAL CHANGE WHENEVER DEEMED IT TO BE NECESSARY TO IMPROVE FUNCTION AND QUALITY OF THE PRODUCTS.

- ASSEMBLY OPERATIONS MUST BE PERFORMED BY A SKILLED TECHNICIAN AND MUST BE SCRUPULOUSLY OBSERVED.

- BEFORE MOUNTING THE CLUTCH MAKE A COMPLETE INSPECTION OF THE MOTORBIKE COMPONENTS, IN ORDER TO VERIFY THE POSSIBLE PRESENCE OF FAULTS OR ANOMALIES ON THE VEHICLE.

- MAKE SURE THAT THERE ARE NO MISSING/DAMAGED PARTS IN THE CLUTCH KIT.

- SOME PARTS OF THE CLUTCH AND ITS COMPONENTS CAN HAVE SHARP SURFACE: HANDLE WITH CARE.

- SOME COMPONENTS OF THE CLUTCH, BECAUSE OF THEIR SMALL DIMENSIONS CAN BE SWALLOWED: KEEP AWAY FROM CHILDREN.

STM ITALY

Via A. Olivetti 15 - 10020 - Riva presso Chieri (TO)

www.stmitaly.com - contact@stmitaly.com

