

0F3SR450A220000

FMV S010

**SLIPPER CLUTCH KIT FOR
MV AGUSTA F4 750,
BRUTALE 910 e BRUTALE 750
with M22x1,5 shaft threading**

ASSEMBLY INSTRUCTIONS

Orig
Bear

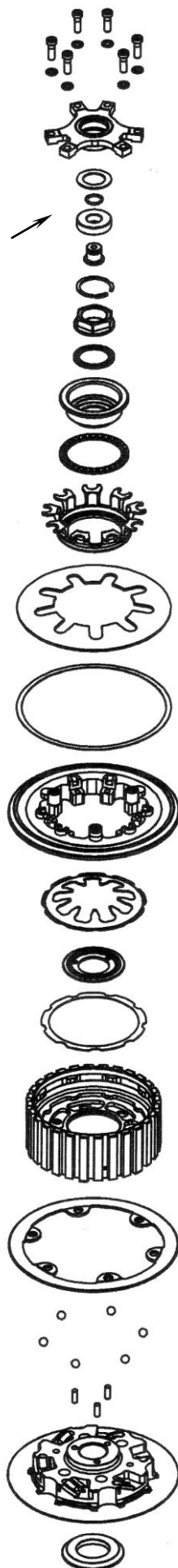

- ← 901VT018
M5x15 screws
- ← 901RD007
M5 toothed washers
- ← 0F3SR450A22R004
Bearing rest
- ← 0F3SR450A220058
Washer
- ← 901SE012
Seal ring
- ← 0F3SR450A220048
Push rod pin
- ← 901SE010
Seal ring
- ← 0F3SR450A220013
Nut M22x1,5
- ← 0F3SR540D220017
Notched washer M22
- ← 0F3SR450A220007
Spring stopper hub
- ← 003MGP07
Ball bearing
- ← 0F3SR620E070008
Spring pusher washer
- ← 0S1125
Evoluzione racing spring
- ← 003SUZ118
Primary spring support
- ← 0F3SR230C220003
Pressure plate
- ← 0S2085
Secondary spring
- ← 0F3SR450A220009
Drum stopper hub
- ← 0F3SR540B140016
Secondary spring support
- ← 0F3SR450A22002C
Drum
- ← 003MG015
Progressive engagement plate
- ← 001MG025
6 steel balls
- ← 0F3CR620E070038
Pins
- ← 0F3SR450A22001C
Hub
- ← 0F3SR450A220045
Washer

- Pre-assemble the hub pack: put progressive engagement plate (003MG015) on hub (0F3SR450A22001C), with the step facing up, put it correctly into its seats, then check that pushing on one side the other side lifts up.
- place at the bottom of the grooves the 6 steel balls (001MG025) onto the hub (0F3SR450A22001C) using a small amount of grease. With an M6 screw fix the clutch drum (0F3SR450A22002C) onto the clutch hub (0F3SR450A22001C) in an at-rest position.
- Make sure that the washer of the original clutch, placed in the basket, is replaced by the STM washer (0F3SR450A220045) included in the package.
- Insert the hub pack onto the main shaft.
- Reinstall the clutch plates remembering to remove the two rings and to respect the position as in the original clutch. The total thickness of the disc pack should be 42.5 mm.
- Remove the screw used to hold hub (0F3SR450A22001C) and drum (0F3SR450A22002C) together.
- Insert the drum stopper hub (0F3SR450A220009) into the hub housing (0F3SR450A22001C) taking care that the three pins (0F3CR620E070038) inside the hub (0F3SR450A22001C) place themselves in the three holes present on the drum stopper hub (0F3SR450A220009) and that they are on a level with the superior surface of the drum stopper hub.
- Verify that the secondary spring support (0F3SR540B140016) is well inserted into its own housing inside the drum (0F3SR450A22002C).
- Insert the secondary spring (0S2085) in its seat into the drum (0F3SR450A22002C) with some grease.
- Verify that the primary spring support (003SUZ118) is well inserted in its own housing inside the pressure plate (0F3SR230C220003)
- Insert the Evoluzione Racing spring (0S1125) into the pressure plate (0F3SR230C220003).
- In order, assemble the complete spring stopper kit starting from the spring stopper washer (0F3SR620E070008) with the shaped part facing up as shown in the picture. Insert the load bearing (003MGP07) and the spring stopper hub (0F3SR450A220007).
- Finally, place the complete spring stopper pack inside the Evoluzione racing spring (0S1125) beforehand mounted onto the pressure plate (0F3SR230C220003). At this point insert the pressure plate (0F3SR230C220003) on the drum (0F3SR450A22002C).
- Insert the notched washer (0F3SR540D220017) in the relevant opening placed on the upper part of the spring stopper hub (0F3SR450A220007), with the convex part facing up, then insert and screw the nut (0F3SR450A220013). Lock with the dynamometric key to the torque suggested by the manufacturer.
- Assemble the complete bearing rest: insert the washer (0F3SR450A220058) in its seat in the bearing rest (0F3SR450A22R004) and then fit in the original bearing. After that insert the seal ring (901SE010) in the groove inside the bearing rest (0F3SR450A22R004). After putting the push rod pin (0F3SR450A220048) in the original bearing, insert the seal ring (901S012) in its inner groove.
- Position the bearing rest (0F3SR450A22R004) into the relevant opening of the pressure plate (0F3SR230C220003) taking care to correctly align the openings and fix it with the six screws (901VT018) and with the toothed washers (901RD007) with a torque of 2-3Nm.

NB: once the assembly is complete, repeatedly operate the clutch lever to check that pressure plate correctly performs the opening and closing movements.

GENERAL SAFETY REGULATIONS

- IN THIS SHEET ARE REPORTED THE DIRECTIONS TO PERFORM CORRECTLY THE CLUTCH ASSEMBLY OPERATIONS.
- STM RESERVES THE RIGHT, WITHOUT NOTICE, TO INTRODUCE ANY TECHNICAL CHANGE WHENEVER DEEMED IT TO BE NECESSARY TO IMPROVE FUNCTION AND QUALITY OF THE PRODUCTS.
- ASSEMBLY OPERATIONS MUST BE PERFORMED BY A SKILLED TECHNICIAN AND MUST BE SCRUPULOUSLY OBSERVED.
- BEFORE MOUNTING THE CLUTCH MAKE A COMPLETE INSPECTION OF THE MOTORBIKE COMPONENTS, IN ORDER TO VERIFY THE POSSIBLE PRESENCE OF FAULTS OR ANOMALIES ON THE VEHICLE.
- MAKE SURE THAT THERE ARE NO MISSING/DAMAGED PARTS IN THE CLUTCH KIT.
- SOME PARTS OF THE CLUTCH AND ITS COMPONENTS CAN HAVE SHARP SURFACE: HANDLE WITH CARE.
- SOME COMPONENTS OF THE CLUTCH, BECAUSE OF THEIR SMALL DIMENSIONS CAN BE SWALLOWED: KEEP AWAY FROM CHILDREN.

STM ITALY
Via A. Olivetti 15 - 10020 - Riva presso Chieri (TO)
www.stmitaly.com - contact@stmitaly.com

